

# Mechanical Parallel Roll Thread Rebar Coupler

## Technical Specifications

Bar size	10	13	16	20	25	28	32	40	50
Length	20	30	38	46	58	65	70	90	110
Diameter	15	19	22	30	36	40	46	57	70

Lock-nut	10	10	10	15	15	20	20	25	25
----------	----	----	----	----	----	----	----	----	----

## Installation Procedure

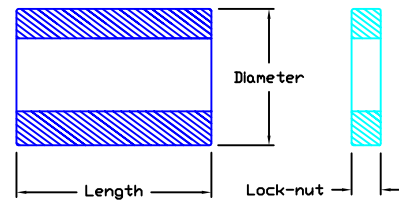

### **Type A : When the connecting bar can be rotated. Consisting of 2 standard threads and 1 coupler**

The first bar is fully engaged inside the coupler.  
The assembly is completed by rotating the connecting bar inside the coupler until full engagement.

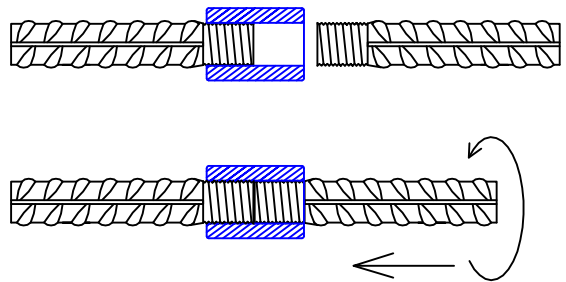

### **Type B : When the connecting bar can't be rotated. ( Too long & too heavy to turn the bar or bend bar. ) Consisting of 1 standard threads, 1 extended thread and 1 coupler**

The first bar having a standard thread is placed in position.  
The coupler is fully engaged onto the extended thread of the connecting bar. The assembly is completed by butting the bars end to end and screwing back the coupler onto the first bar until full engagement.

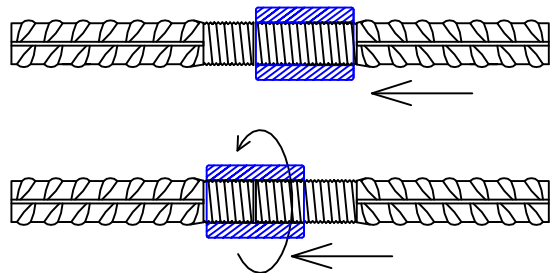

### **Type C : When the connecting bar can't be rotated. Consisting of 1 standard threads, 1 extended thread 1 coupler and 1 Lock-nut.**

The assembly method is similar to the Type B with the addition of one lock-nut to maintain the coupler in position.

